



Sawgrass Expressway and Atlantic Boulevard Interchange Improvement Project

Project Description

Florida's Turnpike Enterprise is improving the existing interchange at Sawgrass Expressway/SR 869 and Atlantic Boulevard (Exit 8) in Broward County. This project includes:

- Widening the existing roadway from 6 to 10 lanes from north of Commercial Boulevard (Exit 5) to north of Atlantic Boulevard (Exit 8)
- Replacing the Sawgrass Expressway bridges over Atlantic Boulevard to address flooding
- Reconstructing the northbound and southbound Sawgrass Expressway entrance and exit ramps at Atlantic Boulevard
- Widening eastbound Atlantic Boulevard from two to three lanes and constructing a new bike lane from Sawgrass Expressway to NW 121 Terrace
- Widening westbound Atlantic Boulevard from two to three lanes and constructing a new bike lane from Lakeview Drive to Sawgrass Expressway
- Enhancing stormwater management at the pond west of the interchange
- Improving signage, pavement markings, signalization, lighting, and drainage

Construction and Traffic Impacts

Construction will take place during both daytime and nighttime hours. Nearby residents and businesses may experience periodic construction light, noise, vibration, and dust through the project's duration. Florida's Turnpike Enterprise takes steps to reduce construction impacts and efforts will be made to limit traffic and noise disruptions.

New lanes constructed as part of this project will open upon the completion of adjacent widening projects. Lane closures will generally take place during off peak hours to minimize traffic congestion and delays for most drivers. Closures will be announced in advance in the South Florida and Treasure Coast Weekly Lane Closures and Work Zone Advisory.

Schedule and Funding

Construction Schedule

Work is anticipated to continue through early 2026.

Cost and Funding

The project cost is approximately \$72.5 million.

Public Information

Hector Reyes

Community Outreach Specialist
954-934-1251

– or –

1-800-749-PIKE

Hector.Reyes@dot.state.fl.us

www.FloridasTurnpike.com

[X.com/FloridaTurnpike](https://www.X.com/FloridaTurnpike)



Florida's Turnpike Enterprise
PO Box 9828
Fort Lauderdale, FL 33310-9828

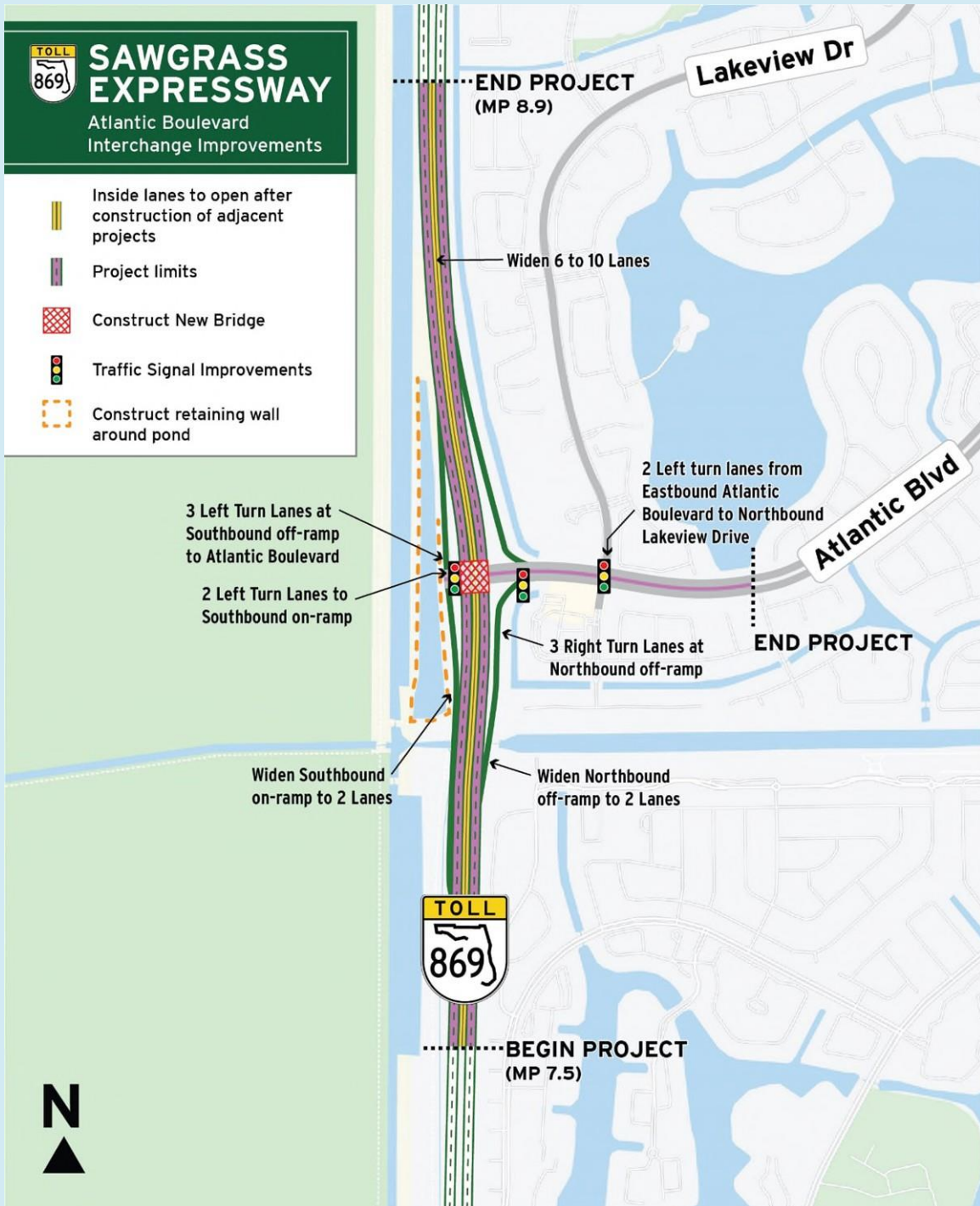

To receive construction updates via e-mail, please contact Hector.Reyes@dot.state.fl.us.